

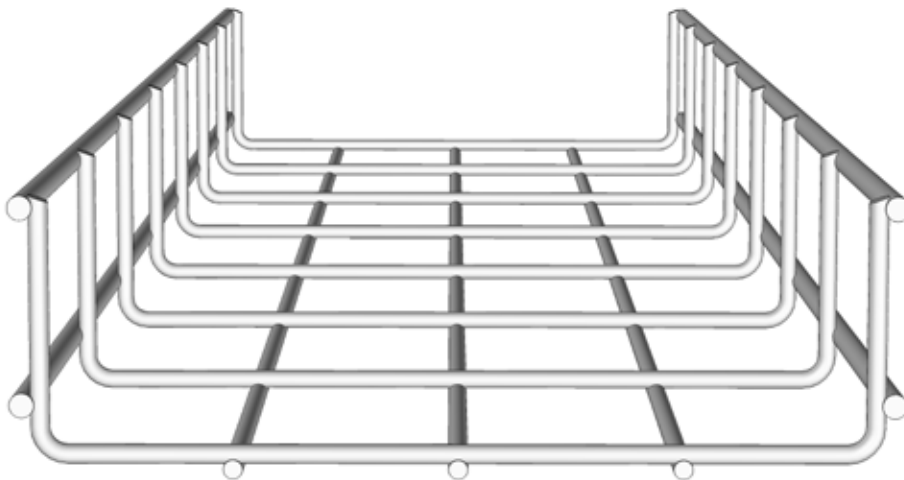

VERGOKAN



Cable Mesh

CM
1



VK/VF60 and VK/VF110 Cable Mesh

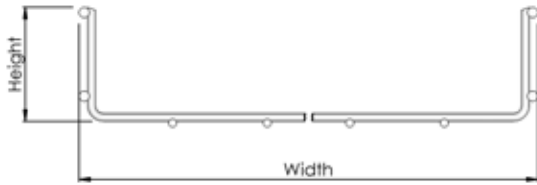

VERGOKAN

Screen Size: 50mm x 100mm
Wire Diameter: Ø4.5mm and Ø5.5mm
Standard Length: 3.0m
Material: Steel
Standard Finish: Zinc Plated

Height:	Width:	Part Number:
60	99	VK/VF60/100 ZP
60	149	VK/VF60/150 ZP
60	199	VK/VF60/200 ZP
60	299	VK/VF60/300 ZP
60	399	VK/VF60/400 ZP
60	499	VK/VF60/500 ZP
60	599	VK/VF60/600 ZP
110	199	VK/VF110/200 ZP
110	299	VK/VF110/300 ZP
110	399	VK/VF110/400 ZP

VK/VF60 Load Diagram

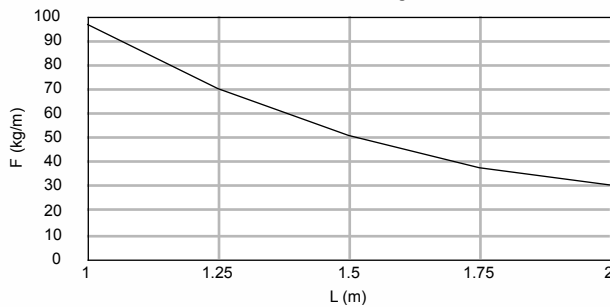

VK/VF110 Load Diagram

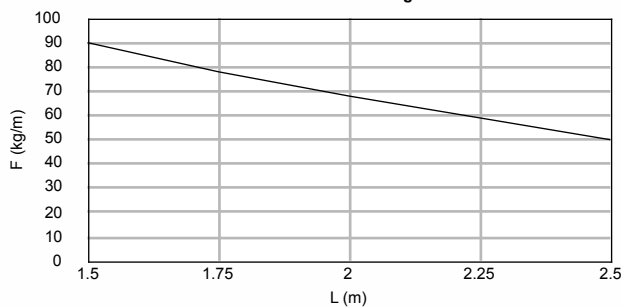

Load Diagrams

These diagrams illustrate the permissible uniformly distributed loads applied to multiple supports. They comply with IEC 61537 par 10.3.3 test type III with connection to 1/5 of the span.

F = max. admissible load (kg/m)
L = support distance (m)
 Max. deflection (m) = L/100

All products manufactured in accordance with ISO9001 Standard

Vergokan Cable Mesh - Accessories

VK/KPVF 60 Snap-On Joiner

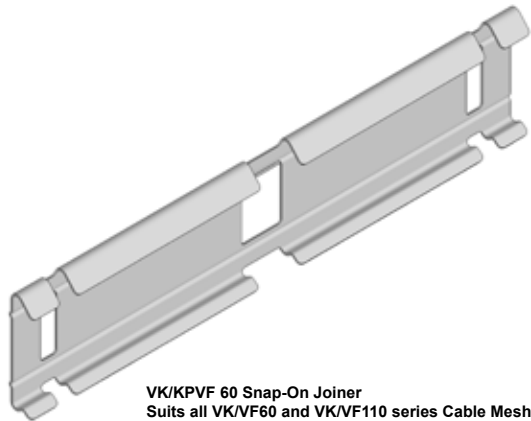
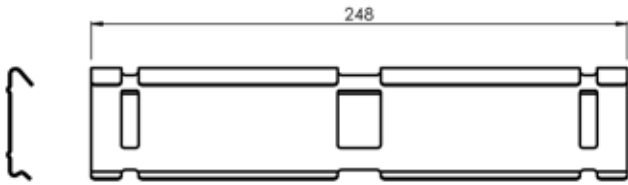

VK/KPVF 60 Snap-On Joiner
Suits all VK/VF60 and VK/VF110 series Cable Mesh

Application Examples:

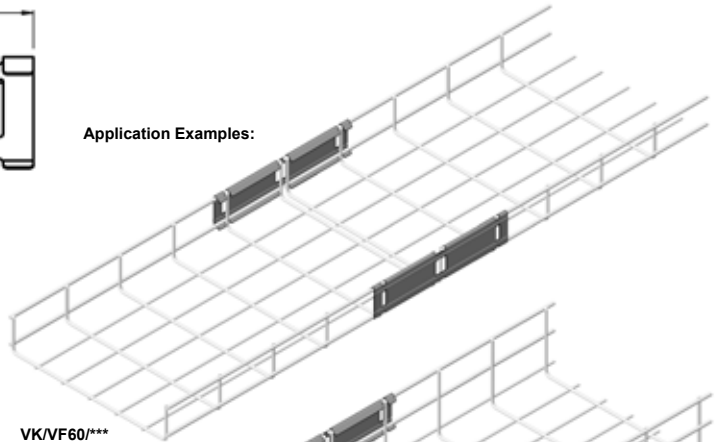

VK/VF60/***

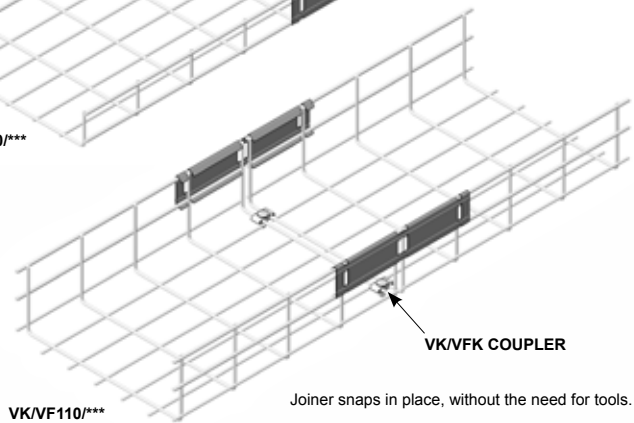

VK/VFK COUPLER

VK/VF110/***

Joiner snaps in place, without the need for tools.

VK/VFK COUPLER



VK/VFK COUPLER

Application Example:

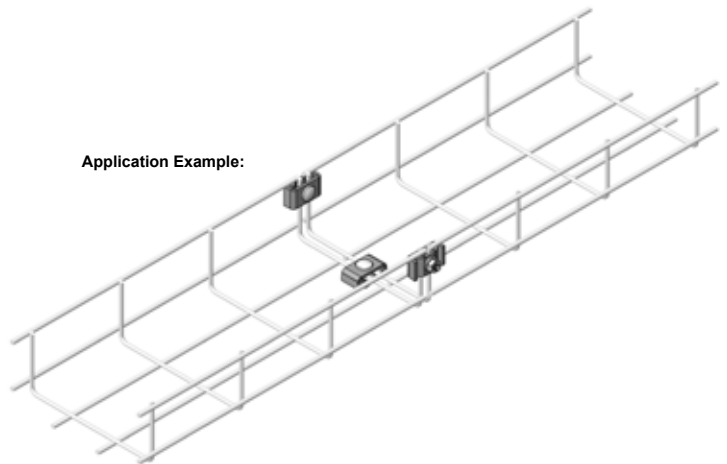

VK/RBC Radius Bend Coupler

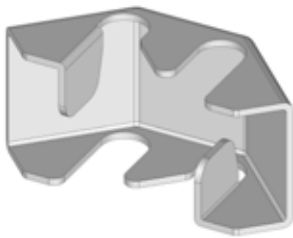
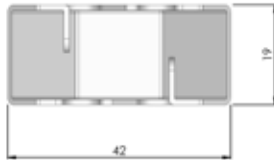
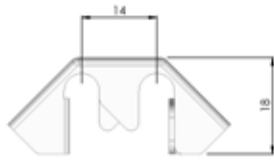

VK/RBC Radius Bend Coupler

Application Example:

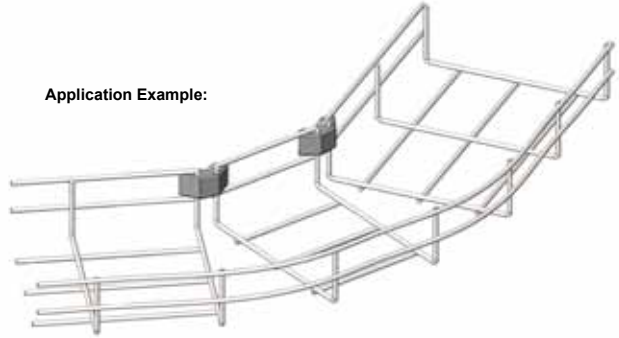

VK/VFMM Mounting Bracket

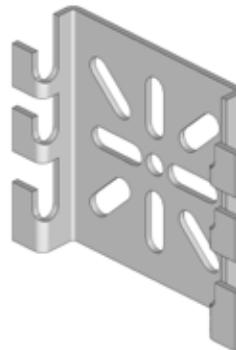
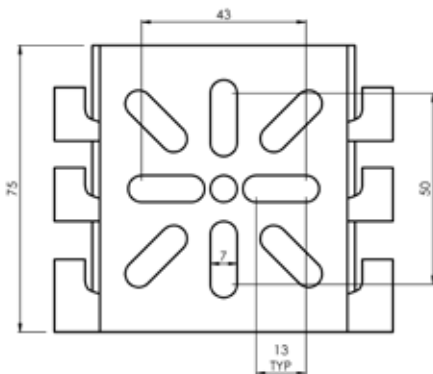
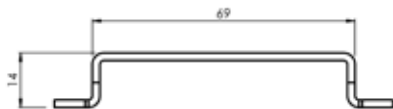

VK/VFMM Mounting Bracket

Application Example:

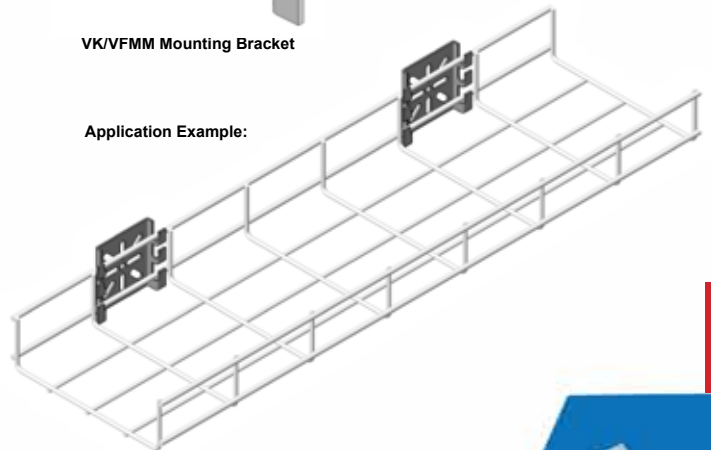

VK/VFO FOR VF Mounting Bracket

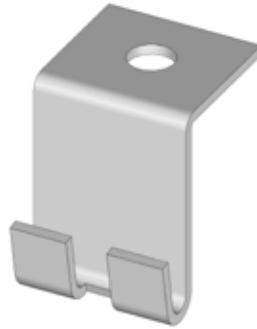
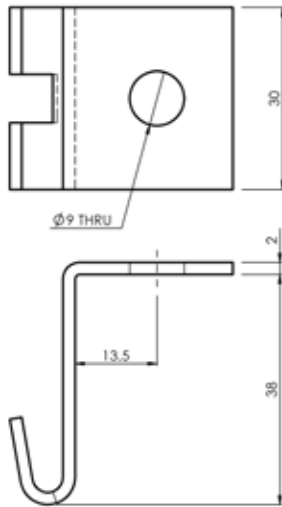

VK/VFO FOR VF Mounting Bracket
Note - this bracket is only suitable for up to 200mm wide Cable Mesh

Application Example:

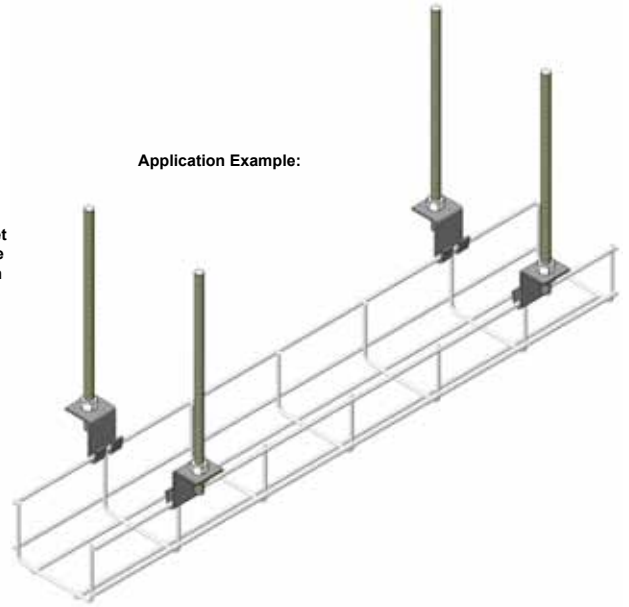

VK/VFM FOR VF Wall Bracket

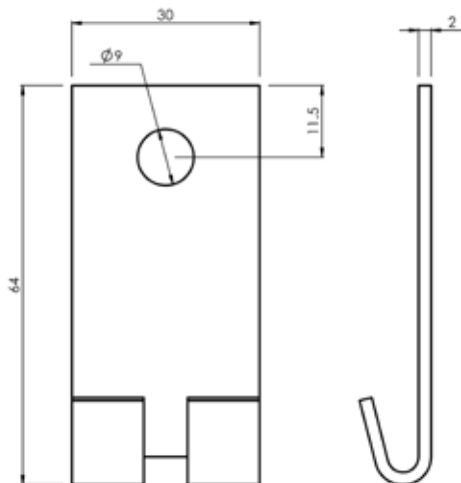

VK/VFM FOR VF Wall Bracket
Note - this bracket is only suitable for up to 200mm wide Cable Mesh

Application Example:

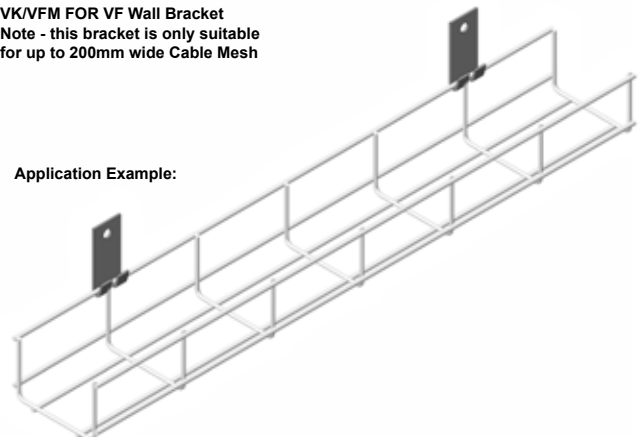

VK/SIS Snap-In Support Profile

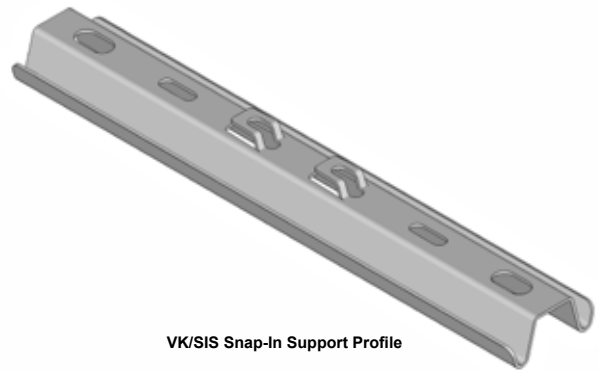
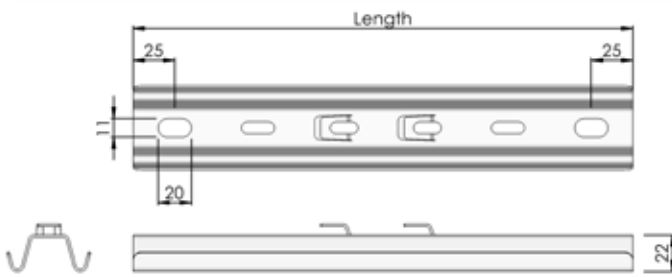

VK/SIS Snap-In Support Profile

Material: Steel

Standard Finish: Pre-Galvanised

Suitable as a floor bracket or for mounting with threaded rod (M8-M10)

Length:	To suit Cable Mesh width when used as a floor bracket:	To suit Cable Mesh width when hanging from threaded rod:	Max. Load (kg)	Part Number:
200	100	100	350	VK/SIS 200
300	150	150	250	VK/SIS 300
350	200	200	200	VK/SIS 350
450	300	300	150	VK/SIS 450
550	400	400	100	VK/SIS 550

Application Example:

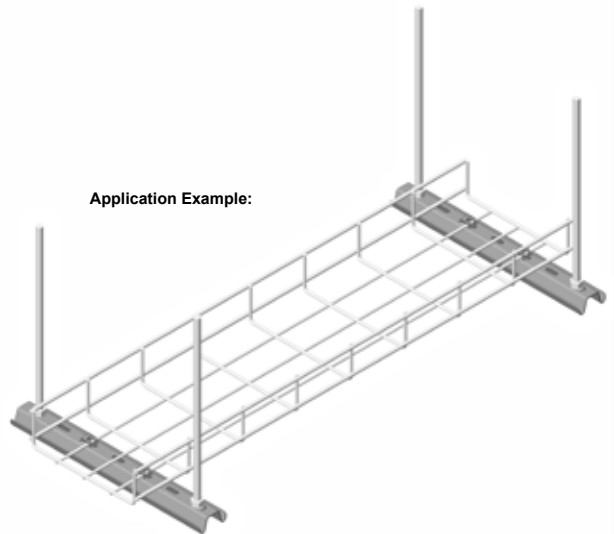

When hanging from threaded rod:

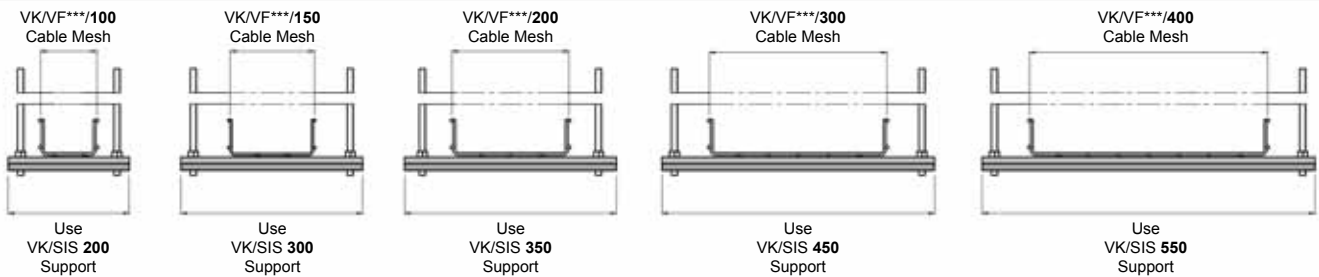

When used as a floor bracket:

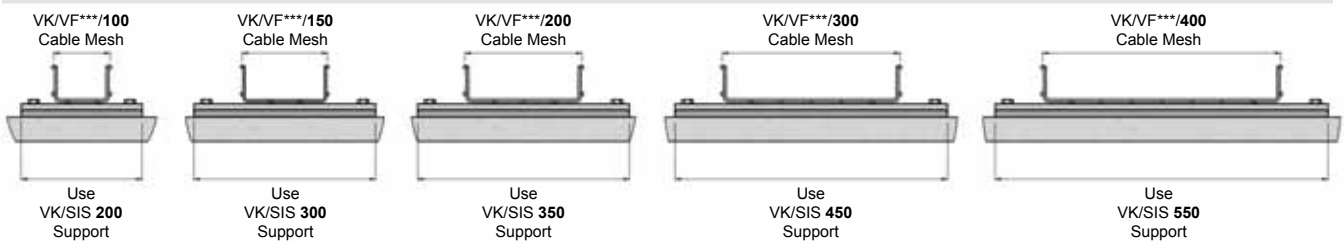

Vergokan Cable Mesh - Accessories

VK/SB Strengthening Bar

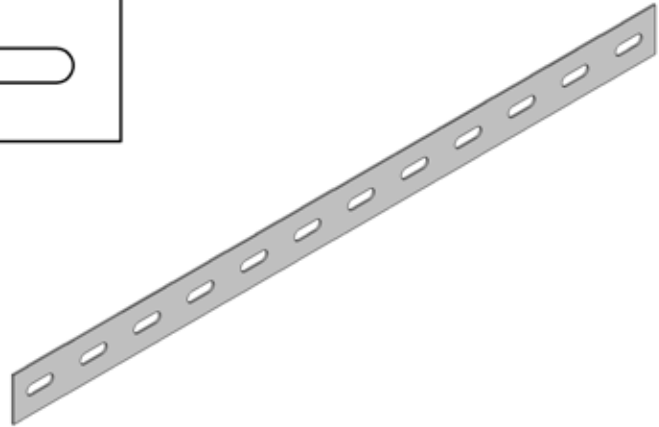
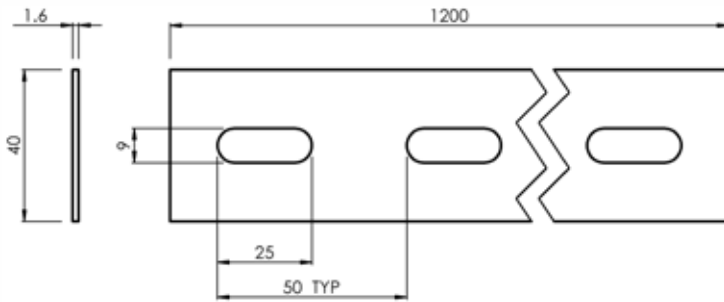

VK/VF WIRE BOLT CUTTER



VK/VF WIRE BOLT CUTTER
Powerbuilt 14" wire bolt cutters,
recommended for cutting Cable Mesh

CM
8

All products manufactured in accordance with ISO9001 Standard